

Hallcroft Community Centre

Front of Leaflet

HALLCROFT COMMUNITY CENTRE

Randall Way
Hallcroft
Retford DN22 7GR

Capacity: 80 Dancing
70 Seated
15 Meeting Room

Room layout:

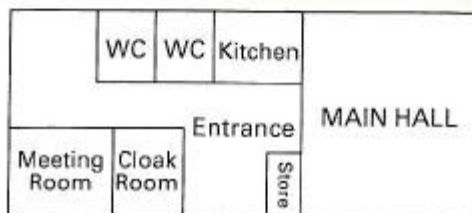

To view or to book, ring
01909 533177

| | |
|-----------------------------|---|
| Kitchen | ✓ |
| Cooking facilities | ✓ |
| Licensed for alcohol* | X |
| Dance area | X |
| Meeting room | ✓ |
| Disabled toilet | ✓ |
| Access for wheelchair users | ✓ |
| Storage space | ✓ |
| Car park | ✓ |
| *see over | ✓ |



Working in partnership with
Bassetlaw District Council

Back of Leaflet

Please read this information regarding the use of the Community Centre.

1. The centre is not licensed to provide any alcoholic beverages. You may however find a publican who has a licence and would be willing to provide a bar for your function.
2. Please leave the centre clean and tidy and on time in accordance with the booking made.
3. All electrical equipment brought into the centre to be used by the hirer must be PAT tested to ensure it complies with Electricity at Work Regulations 1989, Regulation 4, Paragraph 2. Your local electrician will do this for you.
4. Hirers are asked to provide their own tea towels.
5. Any breakages should be reported to the Caretaker at the end of the function. Hirers will be expected to pay for any such damage.

FIRE SAFETY

The Community Centre has the following:

Red (water) fire extinguishers to be used on wood, paper and textiles.
Silver (water) fire extinguishers to be used on wood, paper and textiles.
Beige (foam) fire extinguishers to be used on any type of fire EXCEPT electrical.
Blue (powder) fire extinguishers to be used on liquid or electrical fires.
There is also a fire blanket located in the kitchen area.

In the event of a fire, the building must be evacuated immediately. Call the Emergency Services immediately giving them the location of the fire.

It is strongly recommended that you let everyone attending the function know where the fire doors are located, and that they must leave the building via these exits should a fire break out.