

Technical Note

Date: 9 December 2024

Project: Proposed Solar Farm & Battery Energy Storage System
Land Adjacent to the A614, Worksop, S80 3PA

Title: Access Visibility Review

1. Introduction

- 1.1 This Note has been prepared to provide supplementary information in respect of visibility splays at the access junction proposed to be used as a construction and maintenance access for the proposed solar farm and battery energy storage system on land adjacent to the A614, Worksop.
- 1.2 The proposal will use an existing access junction on the A614. The existing junction features a right turn ghost island. Countdown signs are present on the approach to the junction from the north to highlight the presence of the junction to approaching drivers. Improvements are proposed to the junction to better accommodate construction vehicle access.
- 1.3 A Transport Statement and Construction Traffic Management Plan was prepared by SK to inform the planning application. This Note supplements the information provided in that document, in response to the request from the local highway authority for more detailed information on visibility splays at the junction.
- 1.4 A topographic survey has been undertaken and the proposed access improvements transferred onto the topographic base. Visibility splays are shown in the horizontal and vertical planes in the drawings appended to this Note, with commentary below.

2. Visibility Splay Review

Visibility to North

- 2.1 The northern visibility splay is shown in Appendix A. Two existing signs are present within the splay, these are:
Sign 1: Parking sign – small fingerpost mounted sign
Sign 2: Countdown sign - rectangular sign (standard dimensions 1200mm height x 700mm width), mounting height 200mm
- 2.2 These signs are mounted within the visibility splay of the junction. It is an existing junction and one of the two signs is a countdown sign to advise approaching drivers of the presence of the junction.
- 2.3 Considering the effects of the signs on visibility, Sign 1 is a small fingerpost mounted sign and would not be expected to cause any significant degree of obstruction. This sign has therefore not been reviewed in any more detail.
- 2.4 Sign 2 is a larger rectangular sign. The effects of this sign have been reviewed in terms of its impact on lateral visibility and the vertical envelope.
- 2.5 The vertical profile shows that there is a crest in the road and that the sign is present at the brow of the crest, when viewed from either extent of the visibility splay.
- 2.6 In the horizontal plane, the sign is shown to obscure a maximum width of 1.27m, at the furthest extent of the splay. A car would not be fully obscured by the sign.
- 2.7 In the vertical plane, the sign is mounted at the crest in the road and will effectively obscure the vertical envelope of visibility, over the width indicated above.
- 2.8 It is noted that the crest itself will obscure a small portion of the lower envelope, this has been assessed and the effect of the crest is such that, from the lower end of the driver's eye height, the minimum object height that can be seen is 0.46m.

- 2.9 It is likely that the countdown signs were installed due to the effect of the crest on visibility.

Visibility to South

- 2.10 The southern visibility splay is shown in Appendix B.
- 2.11 A direction sign and associated safety fencing is present within the verge on the southern side of the access. These are outside the visibility splay.
- 2.12 There is no obstruction to the vertical envelope of visibility.

3. Conclusions & Recommendations

- 3.1 The horizontal and vertical visibility splays have been constructed on a topographic survey base. The full visibility splay to the south of the junction is achieved in both planes. There is a crest in the road and two road signs that affect the northern splay and the effects of these have been considered.
- 3.2 There is a crest present on the north side of the access that will obstruct the lowest portion of the vertical envelope of visibility. The effect is relatively minor. Countdown signs have been installed on this approach to highlight the presence of the access to approaching drivers, these signs may have been installed in response to the effect of the crest on visibility. One of the signs has been installed within the visibility splay.
- 3.3 The sign will obscure a maximum width of 1.27m, at the maximum extent of the splay, and over the full extent of the vertical envelope, due to its position.
- 3.4 The arrangement has been in place for some time and, as noted in the Transport Statement, there is no adverse safety record at the junction.
- 3.5 The construction traffic management plan includes proposals for the site access to be marshalled by a suitably qualified banksman so that all vehicles and departures are safely controlled. Temporary traffic management measures including appropriate signage for construction traffic will be used to provide warning to other road users of the site access location on approach and to guide construction vehicles.
- 3.6 The measures proposed in the construction traffic management plan will increase the conspicuity of the junction, alerting approaching drivers of the possibility of turning vehicles and plant. It is also proposed that a banksman be present to marshal movements at the access. These measures are considered appropriate precautions for the period of construction at the site. Minimal movements will occur during the operational phase, as with the existing junction.

Appendix A

NOTES

Layout subject to detailed design and confirmation of statutory undertakers' equipment.

Sign 2:
Dimensions 1200mm x 700mm
Mounting Height 200mm

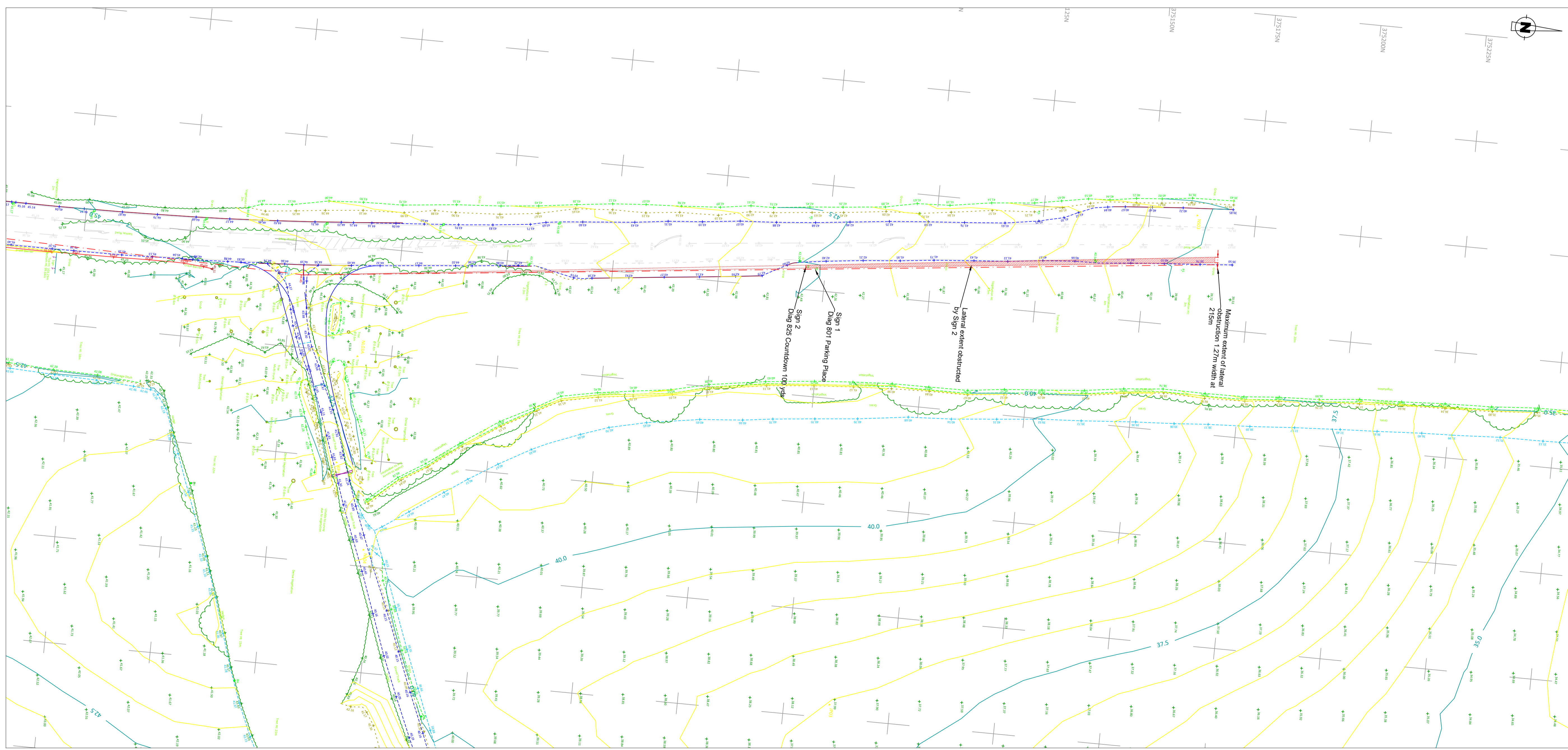
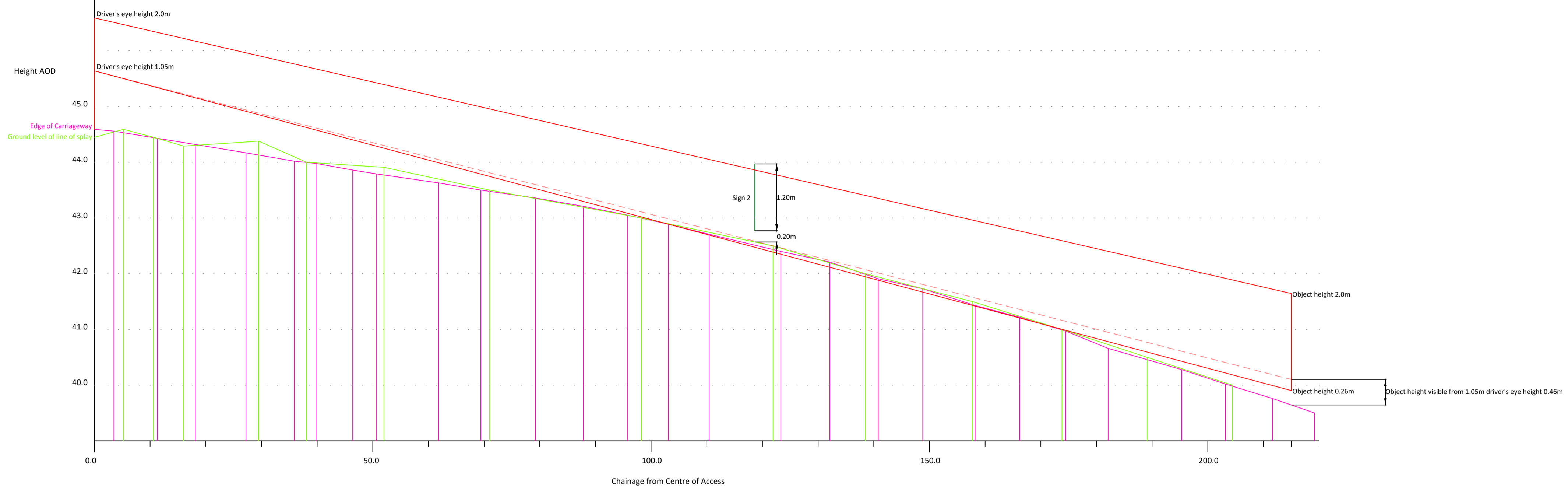

Revision Details	By	Date	Suffix

Drawing Number
SK22410-101

Normanton Larches

Drawing Title
Access Visibility to North Lateral Splay & Vertical Envelope on Topographic Base

Scales at A1
1:500 1:50

Drawn JAT	Approved LGS
Check LGS	Date 06.12.24

Appendix B

THIS DRAWING MAY BE USED ONLY FOR THE PURPOSE INTENDED AND ONLY WRITTEN DIMENSIONS SHALL BE USED

NOTES
 Layout subject to detailed design and confirmation of statutory undertakers' equipment.
 Sign 2:
 Dimensions 1200mm x 700mm
 Mounting Height 200mm

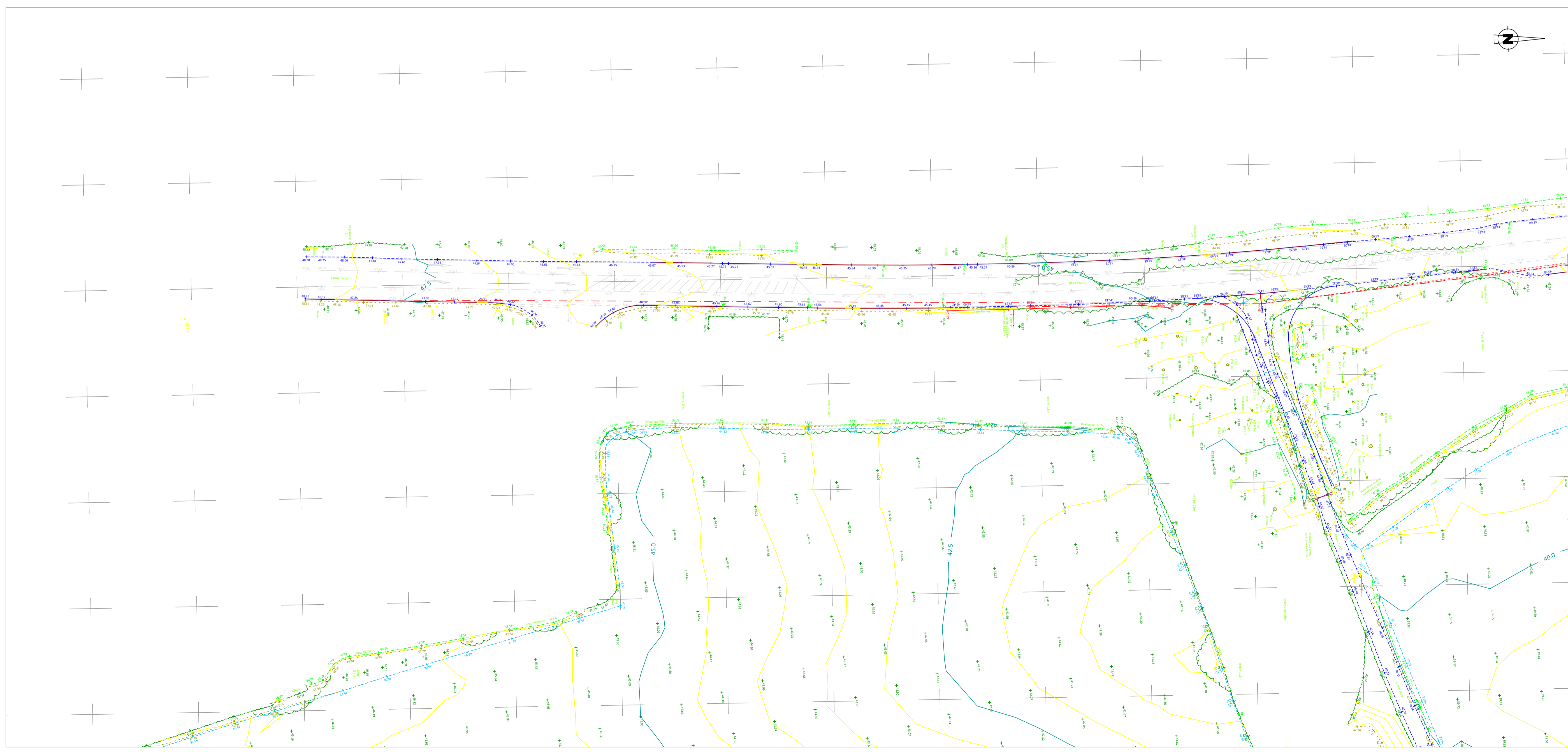
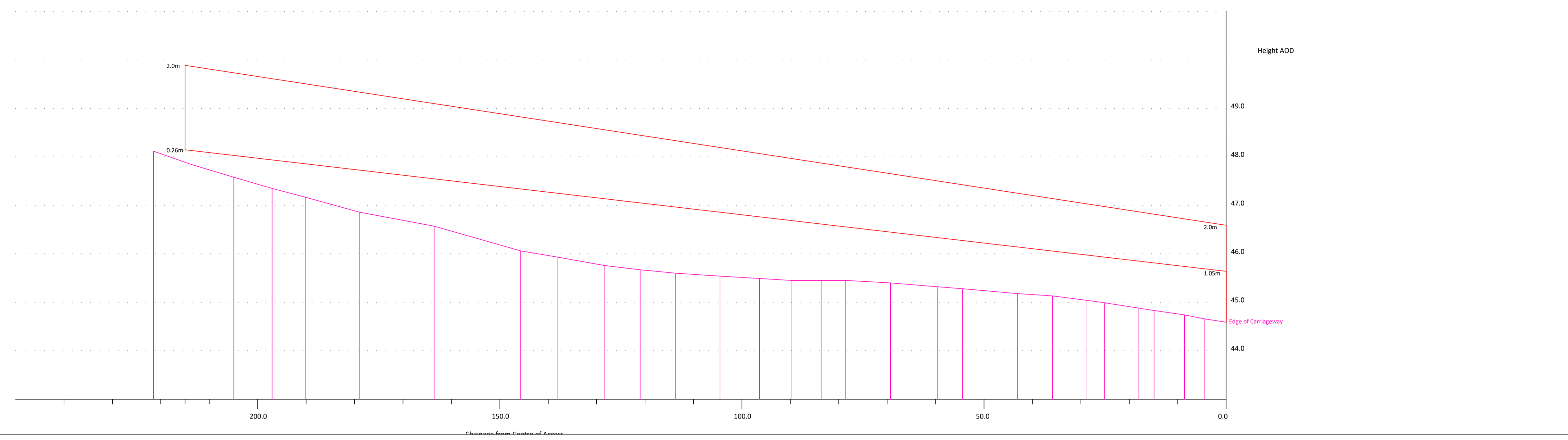

Revision Details	By	Date	Suffix

Drawing Number
SK22410-102

Normanton Larches

Drawing Title
Access Visibility to South Lateral Splay & Vertical Envelope on Topographic Base

Scales at A1
1:500 1:50

Drawn JAT	Approved LGS
Check LGS	Date 09.12.24





Hotel

FROM 12.95
12.95
12.95

WINDY
CLIMBER
PARK
★★★★

Sunday
Lunch
&
Afternoon
Tea
Available Here



